

NOT TO BE USED FOR CONSTRUCTION - INDICATION PURPOSES ONLY - REFER TO SITE SPECIFIC DRAWING

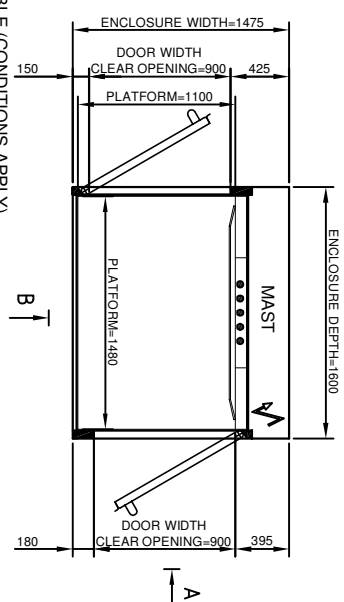
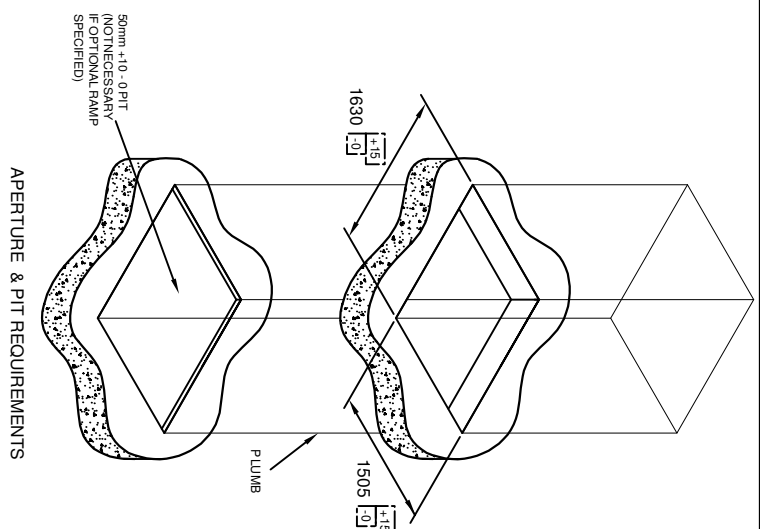
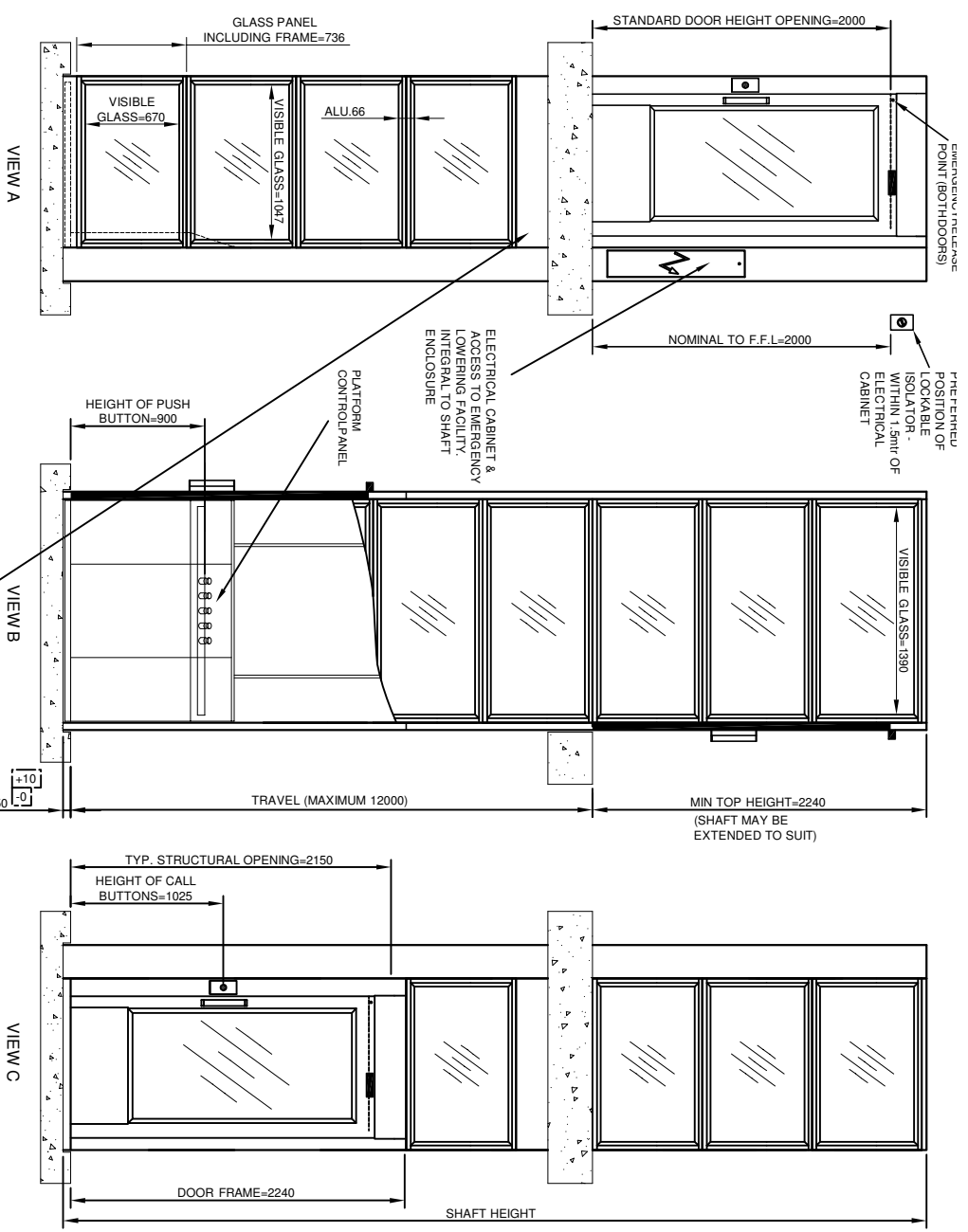

UNLIMITED STOPS AVAILABLE (CONDITIONS APPLY)
 MAXIMUM TRAVEL OF 13 METRES

PRINCIPAL DATA:

TYPE: PLATFORM 2000 PLATFORM LIFT
DRIVE SYSTEM: STATIC SCREW WITH ROTATING NUT
CAPACITY: 410KG OR 500KG
TRAVEL: VARIABLE (UP TO A MAXIMUM OF 9000)
NO OF STOPS: 2 SHOWN (UP TO A MAXIMUM OF 6 AVAILABLE)
SUPPLY VOLTAGE: 400V 3PH 50HZ (SINGLE PHASE AVAILABLE)
RUNNING CURRENT: 4.77AMP
STARTING CURRENT: 18AMP
STANDARD COLOUR: RAL 9003 WHITE
 (OTHER RAL COLOURS AVAILABLE)

DOOR DATA:

TYPE: GL TYPE SHOWN (ALTERNATIVES AVAILABLE)
NO OF DOORS: 2 SHOWN (UP TO A MAXIMUM OF 6 AVAILABLE)
FIRE RATING: AVAILABLE (NOT SHOWN)
OPENING SIZE: 900 X 2000MM
DOOR FRAME: REINFORCED SHAFT ENCLOSURE
DOOR FINISH: VINYL COATED STEEL/ROCKWOOL/STEEL SANDWICH PANNELLING
DOOR GLASS: VINYL COATED STEEL/ROCKWOOL/STEEL SANDWICH PANNELLING
 (POWDER COATED IF ALTERNATIVE OPTIONAL RAL COLOUR SPECIFIED)

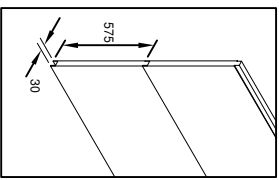

<p>GARTEC An Action Group Company Tel: +44 (0) 1296 397 100 Fax: +44 (0) 1296 397 600 Email: sales@gartec.com www.gartec.com</p>		<p>Midshires Business Park Smeaton Close Aylesbury Bucks HP19 8HL</p>	
<p>PRIME 70004 100 PLATFORM, 2 STOP LIFT, THROUGH CAR, WITH GLASS</p>	<p>Drawn by R.C.</p>	<p>Scale NTS</p>	<p>Date 09/05/11</p>
<p>Drawing No. SALES-203</p>	<p>Issue 4</p>		